

MILLER® ICE-50C

ITEM	CODE	DESCRIPTION
1	177886	Swirl ring - VESPEL®
2	177875	Electrode, long life - HF (pat. pend.)
3	177890	Standard tip
4	180340	Extended electrode, long life - HF (pat. pend.)
5	177876	Extended tip
6	177877	Retaining cap
7	177887	Drag, Shield
8	180341	Machine, Shield
9	177888	Deflector
10		Nozzle retaining cap
11		Spacer complete with springs
11a		Spare springs

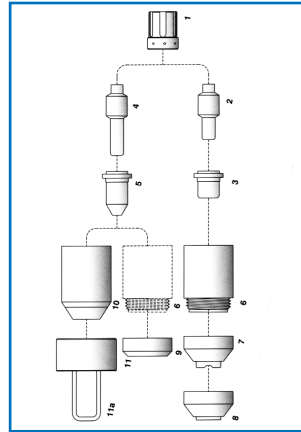

MILLER® APT 3000

ITEM	CODE	DESCRIPTION
1	125-069	Electrode - HF
2	125-070	Tip



MILLER® APT 5000/7000

ITEM	CODE	DESCRIPTION
1	123-899	Electrode - HF
2	123-898	Tip Ø1.0 - 50A
	134-338	Tip Ø1.2 - 70A
3	123-897	Shield cup (APT 5000)

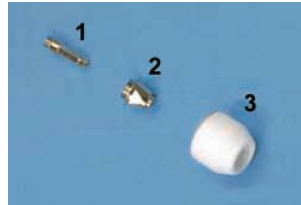

MILLER® APT 8000

ITEM	CODE	DESCRIPTION
1	125-039	Electrode, long life - HF (pat. pend.)
	125-039	Electrode, long life - HF, Teflon cased (pat. pend.)
2	125-038	Tip
3	125-040	Shield cup

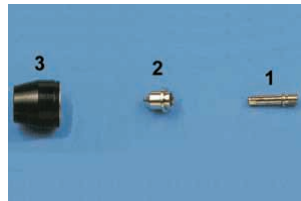

MILLER® ICE-25C

ITEM	CODE	DESCRIPTION
1	176655	Electrode - HF
2	176657	Swirl ring - VESPEL®
3	176656	Tip Ø0.75 - 0.30
4	176658	Nozzle retaining cap

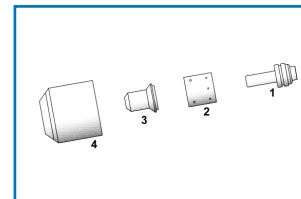

MILLER® ICE-70/ICE-100

ITEM	CODE	DESCRIPTION
1		Hand spare handle with microswitch
2	171257	Torch body (hand) with handle and microswitch
2a		O Ring
3		Machine spare handle
4	171245	Torch body (machine)
5		Front insulator - VESPEL®
6	169217	Electrode, long life - HF (pat. pend.)
7	169222	Swirl ring - VESPEL®
8	169220	Tip Ø1.3 - 0.052 80A
	169227	Tip Ø1.5 - 0.059 100A
9	173816	Electrode, extended, long life - HF (pat. pend.)
10	173814	Tip, extended Ø1.3 - 0.052 80A
	173815	Tip, extended Ø1.5 - 0.059 100A
11		Nozzle retaining cap, outside Ø30.1mm/1.19" (for cutting guide)
12	169219	Contact tip 80A, Ø1.3 - 0.052
	169226	Contact tip 100A, Ø1.5 - 0.059
13		Contact nozzle retaining cap
	169223	Contact nozzle retaining cap, VESPEL®
14	169225	Deflector
15	169224	Spacer for contact cutting, hand
16	169230	Shield cup, machine
17		Spacer for contact cutting, hand (for extended tips item 10)
18		Locking nut
19		Extractor for swirl ring

